

INTERMEDIATE
SKILL

Star Blooms

designed by Marsha Evans Moore
featuring *Jolene* by Whistler Studios

SIZE: 60-3/4" x 81-1/2"



THIS IS A DIGITAL REPRESENTATION OF THE QUILT TOP, FABRIC MAY VARY.

PLEASE NOTE: BEFORE MAKING YOUR PROJECT, CHECK FOR ANY PATTERN UPDATES AT WINDHAMFABRICS.COM'S FREE PROJECTS SECTION.

FREE
PROJECT









Star Blooms

PROJECT DISCLAIMER: Every effort has been made to ensure that all projects are error free. All the information is presented in good faith, however, no warranty can be given nor results guaranteed. Therefore, we assume no responsibility nor damages that may occur when referring to this pattern. When errors are brought to our attention, we make every effort to correct and post a revision as soon as possible. We suggest you check windhamfabrics.com for pattern updates and to test the pattern prior to making the project. **Test templates first, before cutting all the pieces. Free projects are not for resale.**



Note: Please read the entire pattern before you begin. The templates and patterns are found on pages 6. See appliqué instruction before cutting templates.

WOF=WIDTH OF FABRIC

KEY	FABRIC	SKU	YD	CUTTING INSTRUCTIONS
A		53876-1 Black	1-1/8	(6) 5-1/4" x WOF strips; sew ends together. Subcut (2) 5-1/4" x 64-1/2" and (2) 5-1/4" x 53-1/4" borders.
B		53877-1 Black	1-1/8	(10) 3" x WOF fussy cut strips centered over flower motifs; sew ends together. Subcut (2) 3" x 62" strips, (2) 3" x 76-1/2" and (2) 3" x 60-3/4" borders.
C		53878-1 Black	1-3/8	(3) 11-3/4" x WOF strips; subcut (8) 11-3/4" squares. Cut squares in half diagonally twice to make (32) 11-3/4" squares (use 30). (1) 6" x WOF strip; subcut (6) 6" squares. Cut squares in half diagonally once to make (12) 6" triangles.
D		53881-3 Yellow	1/4	(3) 2" x WOF strips; subcut (30) Diamond Templates.
E		53881-4 Lavender	1	(13) 1-3/4" x WOF strips; sew ends together. Subcut (4) 1-3/4" x 62" strips, (2) 1-3/4" x 74" and (2) 1-3/4" x 55-3/4" borders. (2) 2" x WOF strips; Subcut (24) Diamond Templates.
F		53881-5 Rose	7/8	(3) 2" x WOF strips; subcut (30) Diamond Templates. FOR BINDING: (8) 2-1/4" x WOF strips, sew short ends together.
G		53881-6 Petal	1/4	(2) 2" x WOF strips; subcut (24) Diamond Templates.

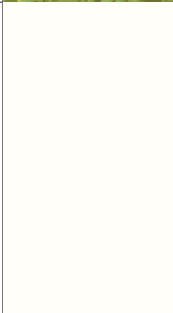

Star Blooms

KEY	FABRIC	SKU	YD	CUTTING INSTRUCTIONS
H		53881-7 Leaf	3/4	(6) 1-3/4" x WOF strips; sew ends together. Subcut (2) 1-3/4" x 62" and (2) 1-3/4" x 43-3/4" borders. For raw edge appliqué: cut (18) Stem Templates. For turned edge appliqué: cut (18) 1-1/4" x 7" bias strips. (36) Leaf Templates.
I		51583-55 Wisp	1	(2) 4-1/8" x WOF strips; subcut (18) 4-1/8" squares. (4) 2-5/8" x WOF strips; subcut (54) 2-5/8" squares. (2) 3" x WOF strips; subcut (18) 3" squares. Cut squares in half once to make (36) triangles. (2) 2-3/8" x WOF strips; subcut (18) 2-3/8" squares. Cut squares in half once to make (36) triangles.
		Backing	5	69" x 89" batting.

ADDITIONAL MATERIALS

Thread to match fabrics
Basic sewing supplies

Sewing machine
Rotary cutter, ruler and mat

Template plastic

Optional: For turned under edge appliqué: freezer paper or other template paper.
For raw edge appliqué: paper backed fusible webbing.

BLOCK ASSEMBLY

- Using your favorite appliqué method, prepare the appliqué pieces. Prepare raw edge appliqué stems in the same way as other pieces. Set aside leaf appliqués.
- For turned edge appliqué stems,** fold (1) H 1-1/4" x 7" strip in half lengthwise with wrong sides together. Sew 1/4" from fold. Trim raw edge 1/8" from stitching. Press stem flat with seam centered on one side. Make (18).
- Trace appliqué pattern to (9) I 4-1/8" squares. Reverse appliqué pattern and trace to (9) I 4-1/8" squares.
- Pin, baste or fuse stem along curved line on I 4-1/8" square. Sew in place along the edges. Make (9) each, Stem Squares and Stem Squares in reverse.

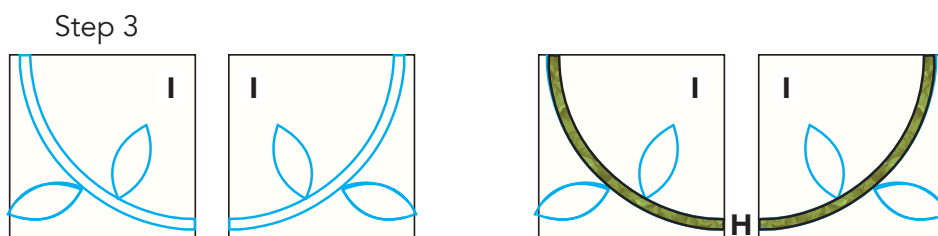
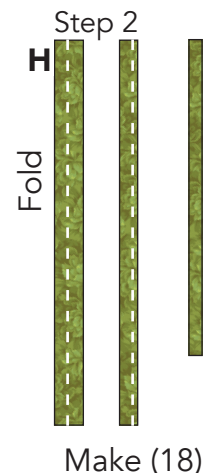



Star Blooms

BLOCKS

Note: Measure and mark the end of the seamline at the side corner on the wrong side, if necessary, to ensure accuracy when sewing the diamonds together.

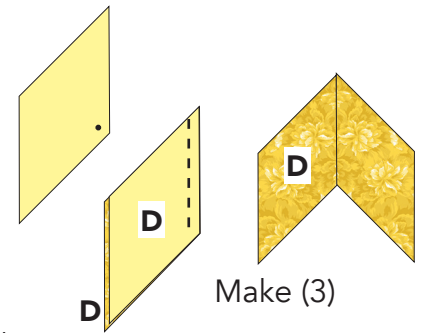

- Sew (2) **D** diamonds together beginning at the center point and ending at the side corner of the seamline to make a diamond pair. Make (4).
- Sew (1) **D** diamond of the diamond pair to (1) **I** 2-5/8" square, ending at the corners of the seamline.
- Sew second **D** diamond to adjacent side of **I** 2-5/8" square beginning at the side corner of the seamline to make a diamond pair unit. Make (3).
- Sew (1) **I** 2-3/8" triangle to (1) side of (2) diamond pair units. Make (1) each, diamond pair with triangle and diamond pair with triangle in reverse.

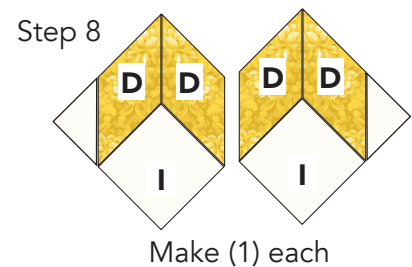
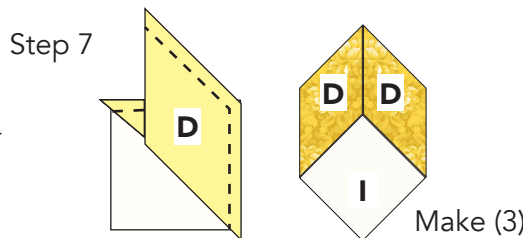
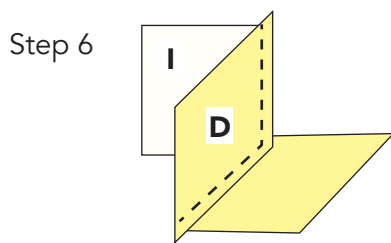

- Sew together (1) diamond pair unit and (1) diamond pair with triangle in reverse ending at the side corner of the seamline to make (1) half block.
- Sew together (1) diamond pair with triangle in reverse and (1) **I** 4-1/8" stem square to make (1) half block.
- Sew the half blocks together, beginning at the top corner of the seamline. Sew (2) **I** 3" triangles between the open points of the diamonds to complete the square.
- Pin, baste or fuse (2) **H** leaf appliques in place on the block. Sew along the edges of the leaves. Block should measure 7-3/4" square including seam allowance. Make (3).
- Following steps 5-12, make blocks using **I** 4-1/8" stem squares in reverse. Make (2).

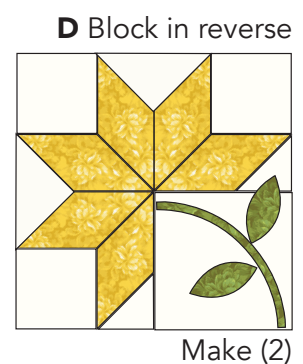
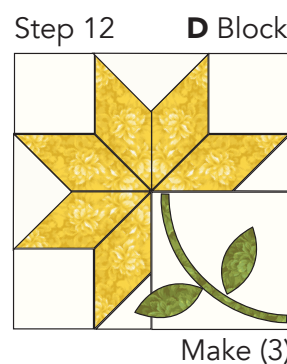
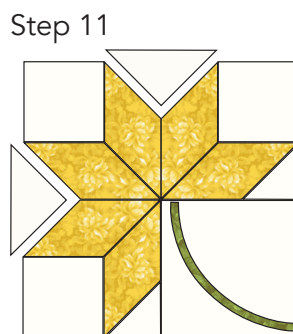
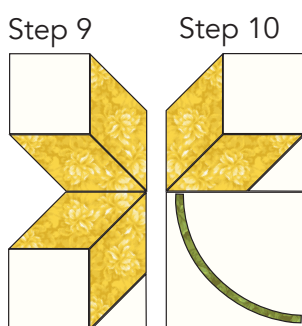



Star Blooms

14. Following steps 5-13, make blocks using **E**, **F**, and **G** diamonds.

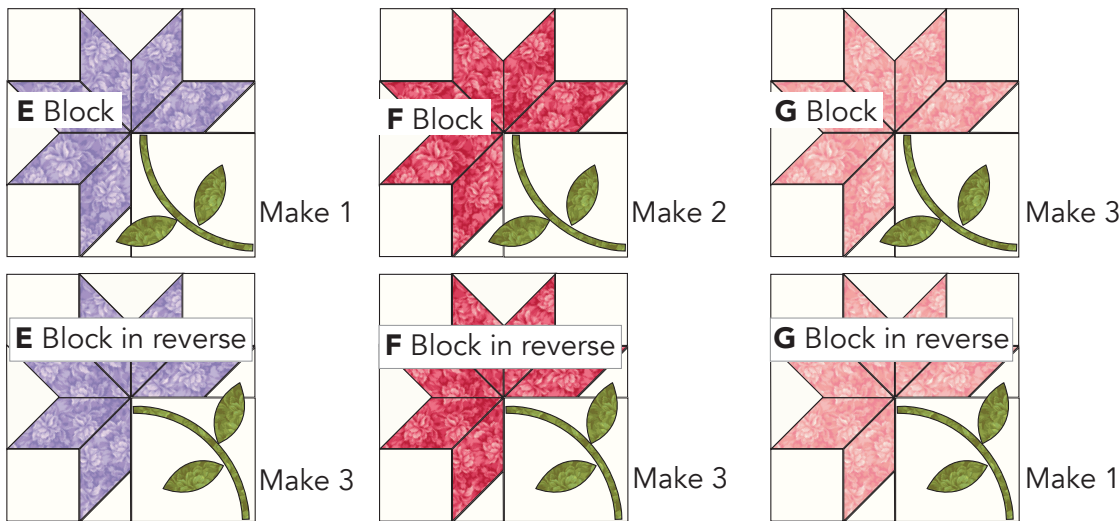

BLOCK ROWS 1 AND 3



Make (2)

15. Arrange (2) **D** blocks, (2) **F** Blocks, (1) **E** block, (1) **G** block, (10) **C** 11-3/4" triangles and (4) **C** 6" triangles into diagonal rows. Note orientation of stems and **C** triangles.

16. Sew together the triangle/block units together, matching seams to make a vertical block row. Block row should measure 10-3/4" x 62" including seam allowance. Make (2).

17. Following the Quilt Layout on page 5, make block row 2 in the same way.

QUILT ASSEMBLY

18. Following the Quilt Layout on page 5, sew (2) **E** 1-3/4" x 62" strips to sides of (1) **B** 3" x 62" strips to make the sashing rows. Make 2.

19. Sew (3) block rows alternating with 2 sashing rows to make the quilt center.

20. Sew (1) **H** 1-3/4" x 62" borders to each side of the quilt.
Sew (2) **H** 1-3/4" x 43-3/4" borders to top and bottom of the quilt.

21. Sew (1) **A** 5-1/4" x 64-1/2" border to each side of the quilt.
Sew (2) **A** 5-1/4" x 53-1/4" borders to top and bottom of the quilt.

22. Sew (1) **E** 1-3/4" x 74" border to each side of the quilt.
Sew (2) **E** 1-3/4" x 55-3/4" borders to top and bottom of the quilt.

23. Sew (1) **B** 3" x 76-1/2" borders to each side of the quilt.
Sew (2) **B** 3" x 60-3/4" borders to top and bottom of the quilt.

FINISHING: Layer quilt top, batting and backing together to form quilt sandwich. Baste and quilt as desired. Bind using **F** 2-1/4" strips.



Star Blooms

QUILT LAYOUT

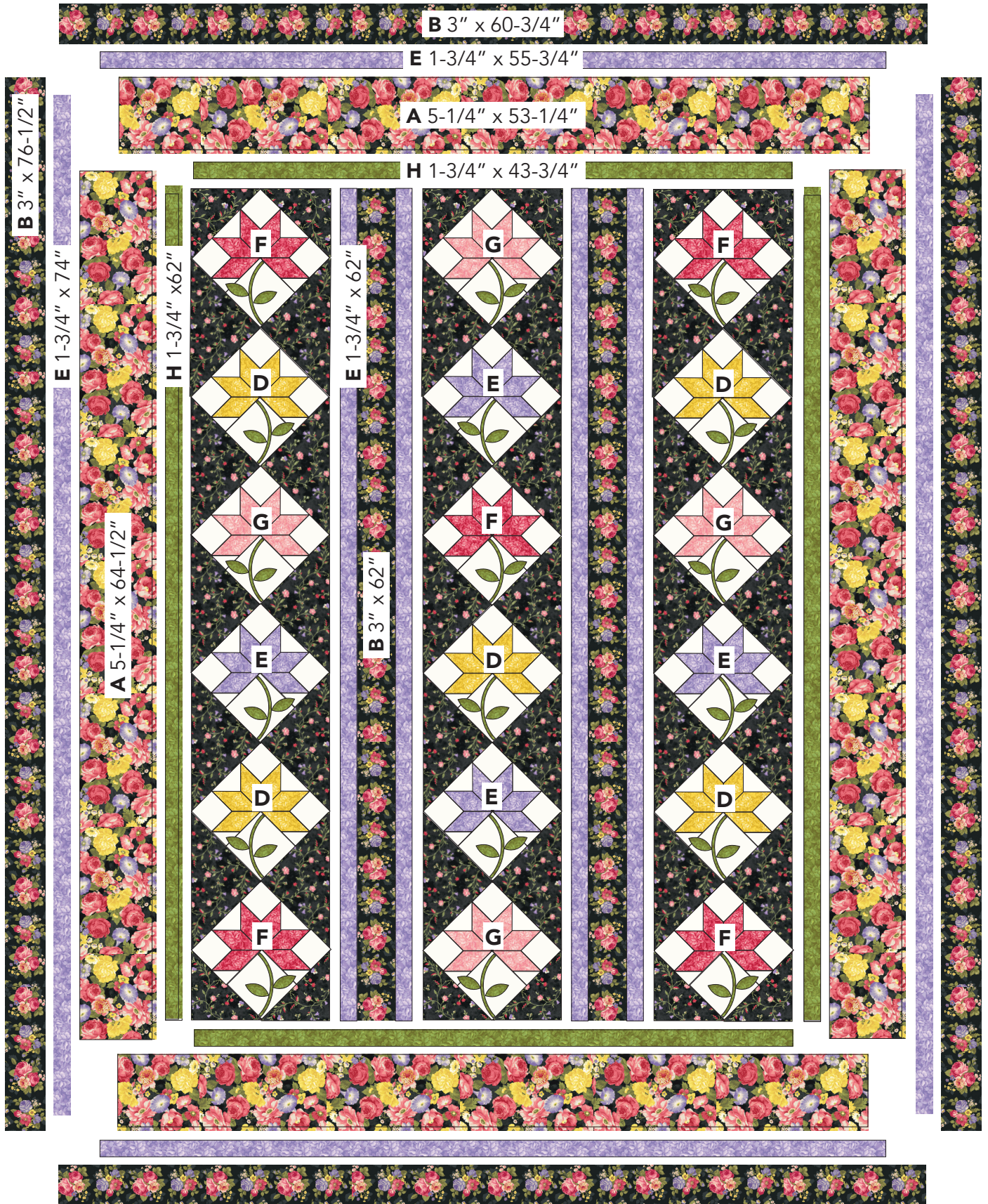



Star Blooms

Templates and Patterns

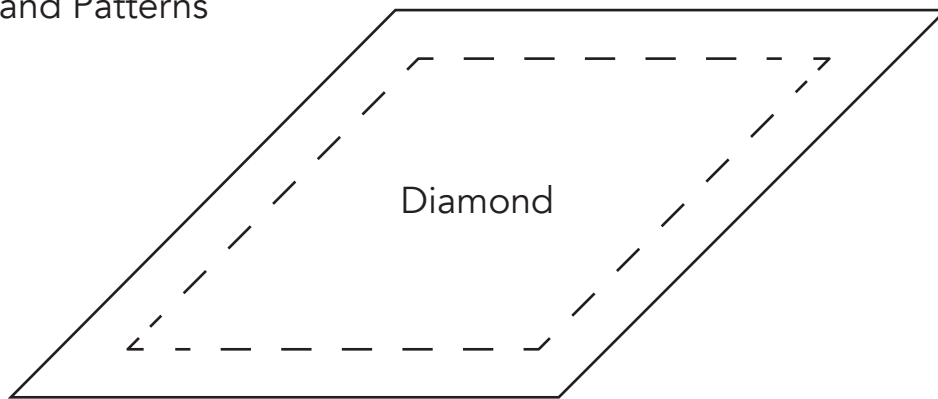

Cut along the outer solid line for turned edge appliqué.

Cut along the inner solid line for raw edge appliqué.

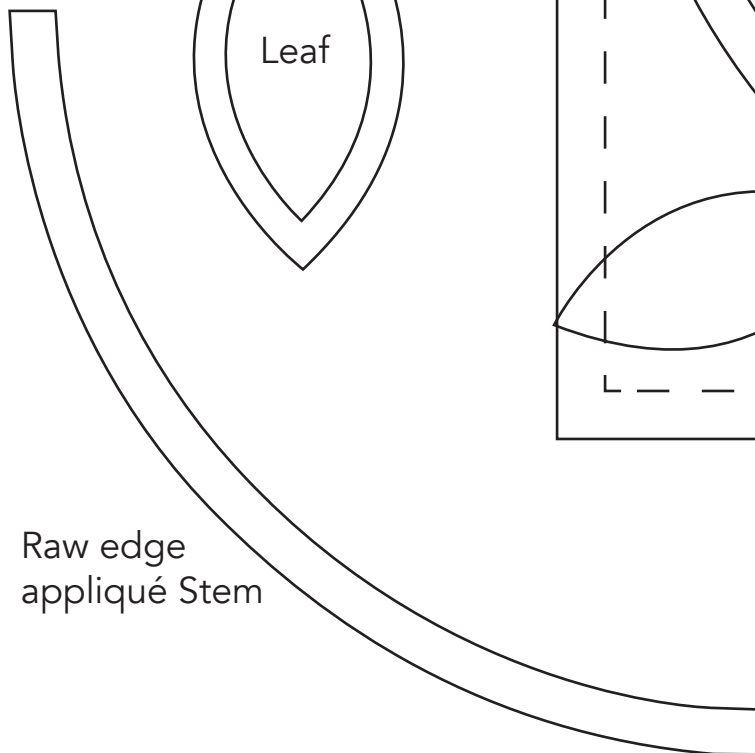
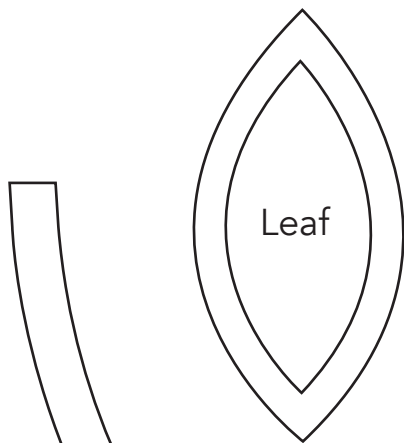

Raw edge
appliqué Stem

Appliqué Pattern

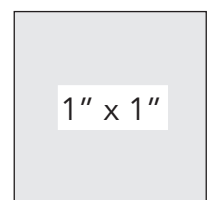
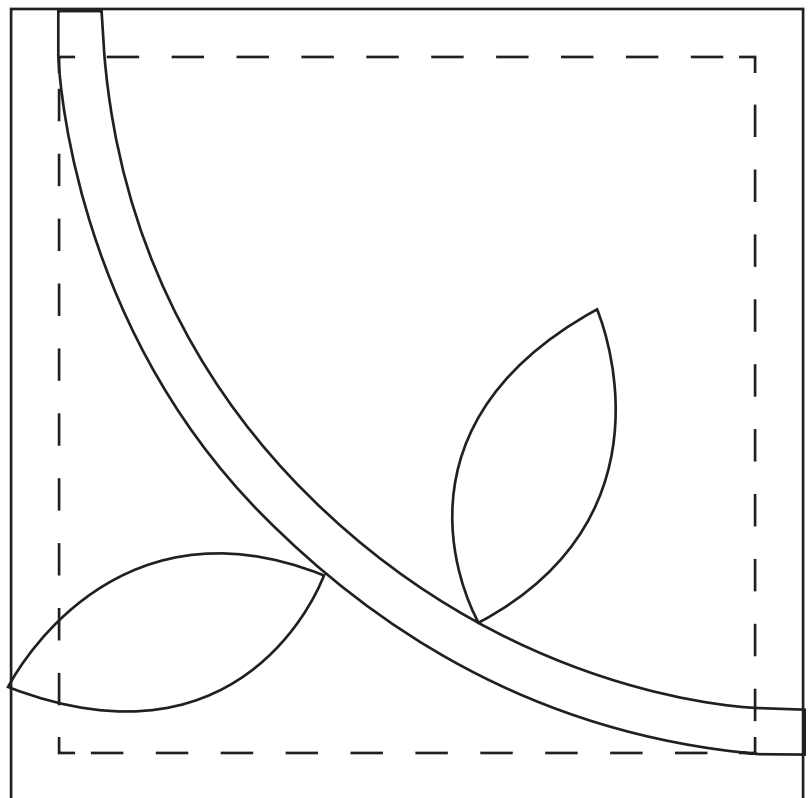

Print at 100%.