

# Flower Meadow

BEGINNER  
SKILL

Designed by Wendy Sheppard  
Featuring *Garden Party* by Whistler Studios

SIZE: 43" x 49"

FREE  
PROJECT



THIS IS A DIGITAL REPRESENTATION OF THE QUILT TOP, FABRIC MAY VARY.





**PLEASE NOTE:** BEFORE MAKING YOUR PROJECT, CHECK FOR ANY PATTERN UPDATES AT WINDHAMFABRICS.COM'S FREE PROJECTS SECTION.

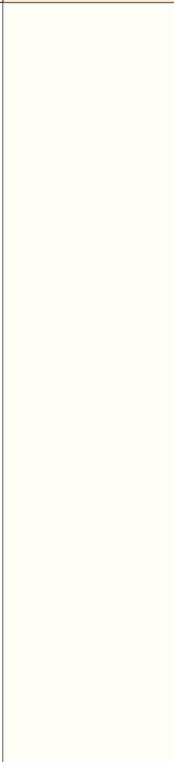

# Flower Meadow

**PROJECT DISCLAIMER:** Every effort has been made to ensure that all projects are error free. All the information is presented in good faith, however, no warranty can be given nor results guaranteed. Therefore, we assume no responsibility nor damages that may occur when referring to this pattern. When errors are brought to our attention, we make every effort to correct and post a revision as soon as possible. We suggest you check [windhamfabrics.com](http://windhamfabrics.com) for pattern updates and to test the pattern prior to making the project. Test templates first, before cutting all the pieces. Free projects are not for resale.



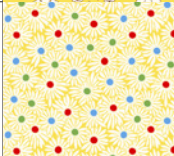



WOF = Width of Fabric

KEY	FABRIC	SKU	YD	CUTTING INSTRUCTIONS
A		51583-55 Wisp	2	<p><b>Flower Block</b>            (1) 6-1/2" x WOF strip; subcut (30) 1" x 6-1/2" rectangles.            (1) 4" x WOF strip; subcut (30) 1-1/4" x 4" rectangles.            (2) 2-3/4" x WOF strips; subcut (30) 1" x 2-3/4" and (30) 1-1/2" x 2-3/4" rectangles.            (3) 1-1/2" x WOF strips; subcut (60) 1-1/2" squares.</p> <p><b>Chain Block</b>            (3) 4-1/2" x WOF strips; subcut (60) 1-1/2" x 4-1/2" and (8) 1-1/2" x 2-1/2" rectangles.            (2) 2-1/2" x WOF strips; subcut (52) 1-1/2" x 2-1/2" rectangles.</p> <p><b>Inner Border 1</b>            (4) 2-1/2" x WOF strips; subcut (2) 2-1/2" x 36-1/2" and (2) 2-1/2" x 34-1/2" strips.</p> <p><b>Inner Border 3</b>            (5) 1-1/2" x WOF strips; subcut (2) 1-1/2" x 39-1/2" strips. Piece remaining (3) WOF strips and subcut (2) 1-1/2" x 43-1/2" strips.</p>
B		53973-X Multi	3/8 (1 REPEAT)	<p><b>Flower Block</b>            (15) 4" tile squares, centering designs.            (4) red, (4) blue, (4) green and (3) yellow.</p>
C		53974-3 Green	1/2	<p><b>Outer Border</b>            (5) 2-1/2" x WOF strips. Piece strips and subcut (2) 2-1/2" x 45-1/2" and (2) 2-1/2" x 43-1/2" strips.</p>
D		53975-2 Yellow	1/4	<p><b>Chain Block</b>            (1) 2-1/2" x WOF strip; subcut (3) 2-1/2" squares.            (1) 1-1/2" x WOF strip; subcut (24) 1-1/2" squares.</p>
E		53977-2 Yellow	3/8	<p><b>Inner Border 2</b>            (4) 2" x WOF strips; subcut (2) 2" x 40-1/2" and (2) 2" x 37-1/2" strips.</p>

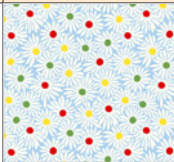

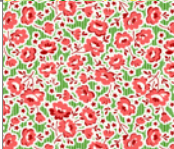
# Flower Meadow

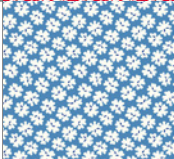
WOF = Width of Fabric

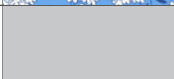
KEY	FABRIC	SKU	YD	CUTTING INSTRUCTIONS
F		53977-4 Blue	1/4	<b>Chain Block</b> (1) 2-1/2" x WOF strip; subcut (3) 2-1/2" squares. (1) 1-1/2" x WOF strip; subcut (24) 1-1/2" squares.
G		53978-2 Yellow	1/8	<b>Flower Block</b> (1) 1-1/2" x WOF strip; subcut (6) 1-1/2" x 2-3/4" and (3) 1" x 3" rectangles.
H		53978-3 Green	1/4	<b>Chain Block</b> (1) 2-1/2" x WOF strip; subcut (3) 2-1/2" squares. (1) 1-1/2" x WOF strip; subcut (24) 1-1/2" squares.
I		53979-3 Green	1/8	<b>Flower Block</b> (1) 1-1/2" x WOF strip; subcut (8) 1-1/2" x 2-3/4" and (4) 1" x 3" rectangles.
J		53980-1 Red	5/8 <small>INCLUDES BINDING</small>	<b>Binding:</b> (6) 2-1/4" x WOF strips. <b>Chain Blocks</b> (1) 2-1/2" x WOF strip; subcut (3) 2-1/2" squares. (1) 1-1/2" x WOF strip; subcut (24) 1-1/2" squares.
K		53980-4 Blue	1/8	<b>Flower Block</b> (1) 1-1/2" x WOF strip; subcut (8) 1-1/2" x 2-3/4" and (4) 1" x 3" rectangles.
L		53981-3 Green	1/8	<b>Flower Block</b> (1) 1-1/2" x WOF strip; subcut (8) 1-1/2" x 2-3/4" and (4) 1" x 3" rectangles.
M		53981-4 Blue	1/4	<b>Chain Block</b> (1) 2-1/2" x WOF strip; subcut (3) 2-1/2" squares. (1) 1-1/2" x WOF strip; subcut (24) 1-1/2" squares.
		Backing	3	51" x 57" piece of batting.



# Flower Meadow

## FLOWER BLOCK

- 1. Blue Flower Unit:** Sew (2) **A** 1-1/4" x 4" rectangles to the left and right sides of (1) **B** 4" tile square, as shown.
- 2. Leaf Unit:** Draw a diagonal line on the wrong side of (1) **A** 1-1/2" square. Place square, right sides together (RST), at the top right corner of (1) **L** 1-1/2" x 2-3/4" rectangle. Sew on drawn line. Trim 1/4" away from sewn line. Open and press to reveal **A** corner triangle. Repeat with another **A** square at the bottom left corner of the same **L** rectangle to make a leaf unit. Repeat to make a mirror-imaged leaf unit, noting seam orientation.
- 3.** Sew (1) **A** 1" x 2-3/4" rectangle to the top, and (1) **A** 1-1/2" x 2-3/4" rectangle to the bottom of sewn leaf unit from **Step 2**.  
For the mirror-imaged unit, sew (1) **A** 1-1/2" x 2-3/4" rectangle to the top of mirror-imaged unit, and (1) **A** 1" x 2-3/4" rectangle to the bottom.
- 4.** Sew **Leaf Units** to the opposite sides of (1) **L** 1" x 3" rectangle to complete stem and leaf unit.
- 5.** Sew **Flower Unit** to the top of **Step 4** unit. Add (2) **A** 1" x 6-1/2" rectangles to the left and right sides to complete a **Flower Block**. Make (4).

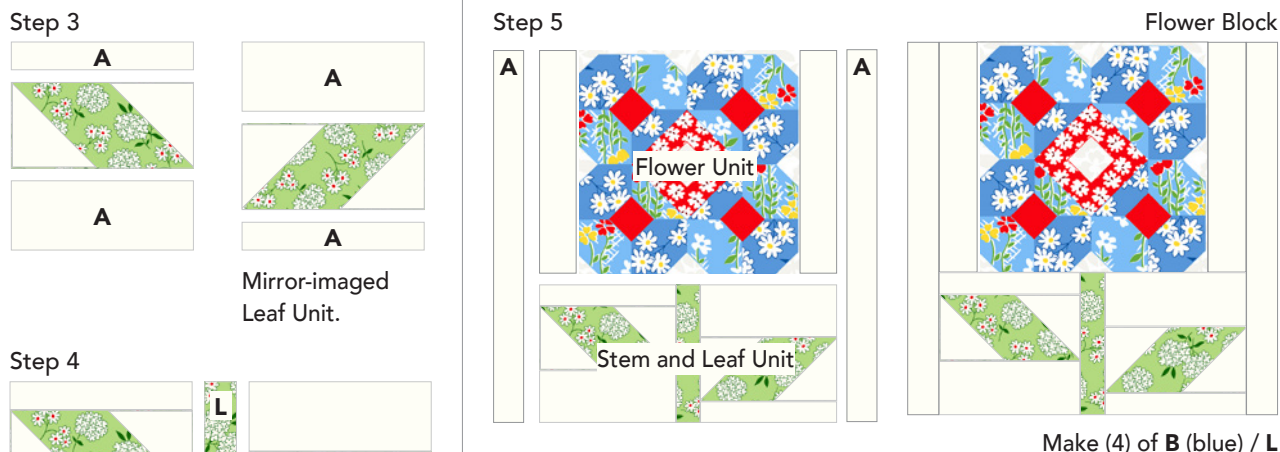
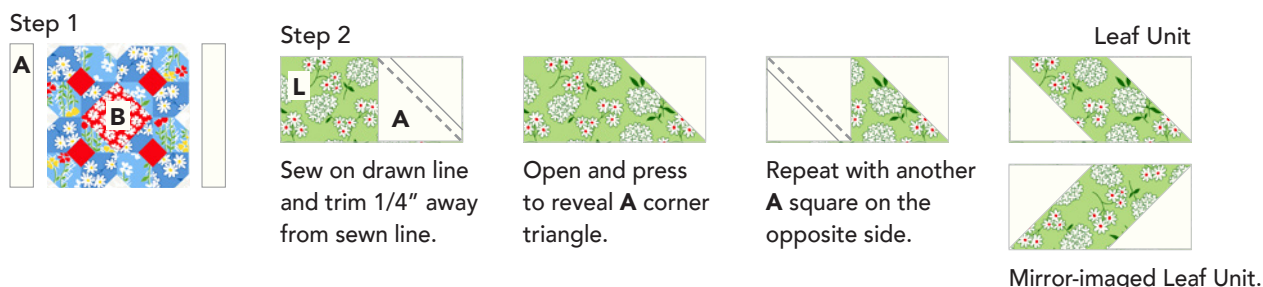



# Flower Meadow

6. Make a total number of **Flower Blocks**, pairing fabric **B** tile square with the indicated leaf print fabric, as shown:

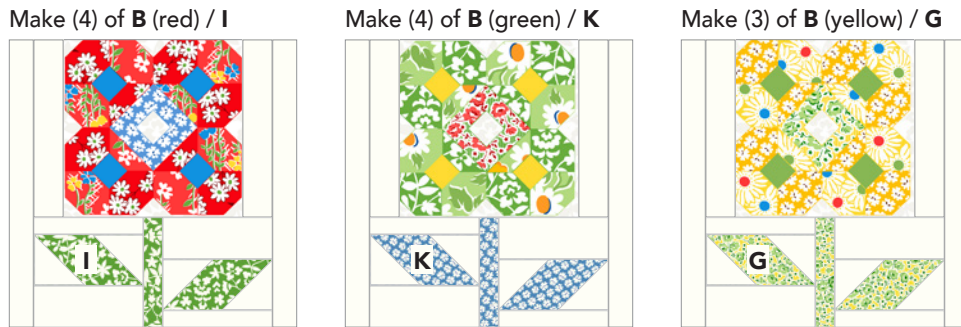

## CHAIN BLOCKS

7. Sew (2) **A** 1-1/2" x 2-1/2" rectangles to the left and right sides of (1) **F** 2-1/2" square to make a row unit.
8. Sew (2) **F** 1-1/2" squares to the opposite sides of (1) **A** 1-1/2" x 2-1/2" rectangle to make a row unit. Make (2).
9. Sew together row units from **Steps 7 and 8**.
10. Sew (2) **A** 1-1/2" x 4-1/2" rectangles to the left and right sides of **Step 9** unit.
11. Sew (2) **F** 1-1/2" squares to the opposite sides of (1) **A** 1-1/2" x 4-1/2" rectangles row units. Make (2).

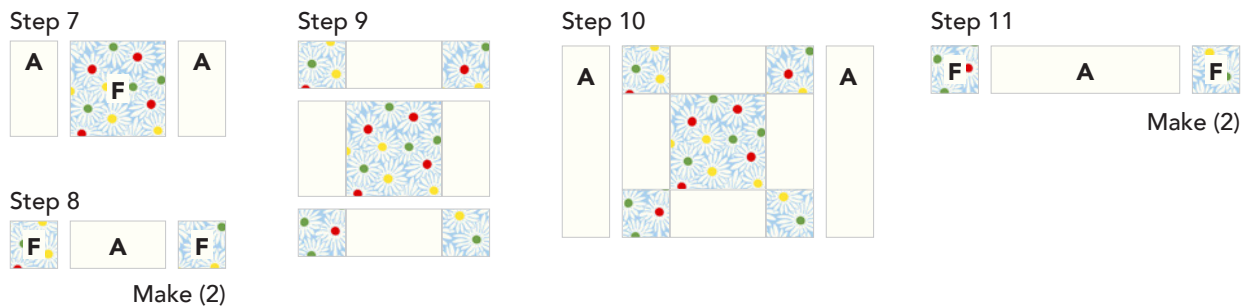

12. Sew together row units from **Steps 10 and 11** to complete (1) **Chain Block**. Make (3).

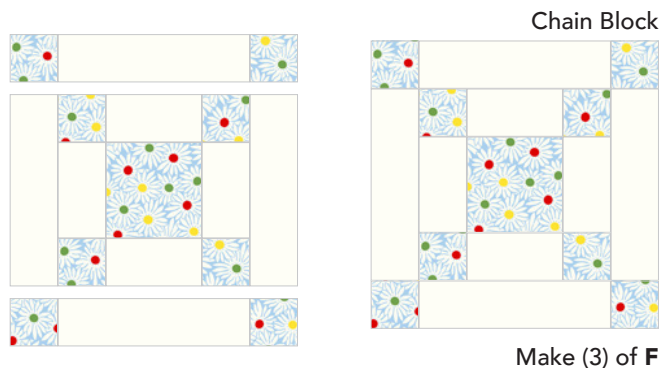



# Flower Meadow

13. Sew a total of (3) Chain Blocks for each of the following prints:

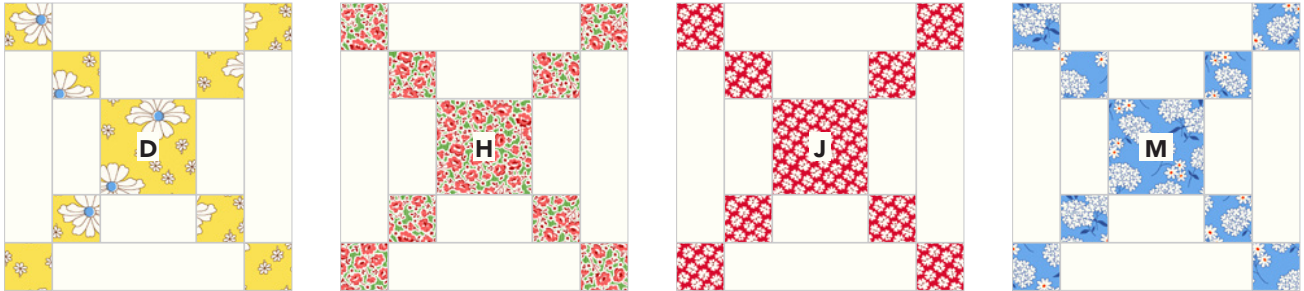

## QUILT TOP ASSEMBLY

REFER TO QUILT IMAGE FOR BLOCK PLACEMENT GUIDE.

14. Pieced Rows: Arrange and sew together (5) alternating Flower and Chain Blocks. Make (5). Row 1 is shown.

Rows 1, 3, 5 - (3) Flower Blocks / (2) Chain Blocks

Row 2, 4 - (3) Chain Blocks / (2) Flower Blocks

15. Sew together Pieced Rows to complete quilt center.

Step 14

Row 1

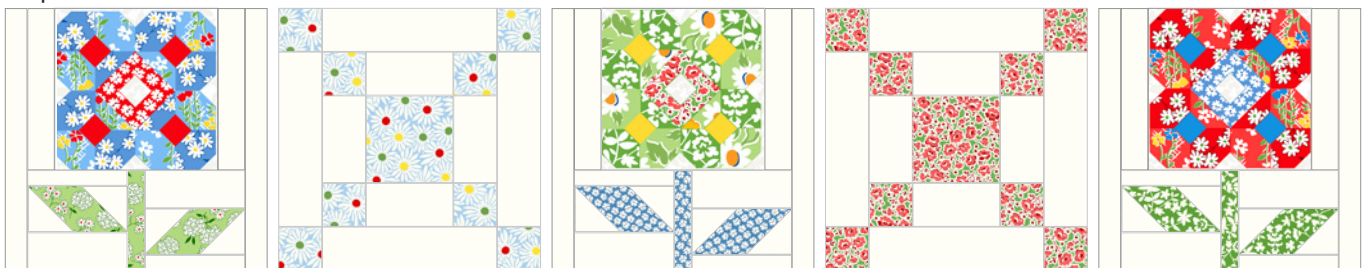

## BORDERS

16. Inner Border 1: Sew (2) **A** 2-1/2" x 36-1/2" strips to the left and right sides of quilt center, followed by (2) **A** 2-1/2" x 34-1/2" strips to the top and bottom of quilt center.

17. Inner Border 2: Sew (2) **E** 2" x 40-1/2" strips to the left and right sides of quilt center, followed by (2) 2" x 37-1/2" strips to the top and bottom of quilt center.

18. Inner Border 3: Sew (2) **A** 1-1/2" x 43-1/2" strips to the left and right sides of quilt center, followed by (2) **A** 1-1/2" x 39-1/2" strips to the top and bottom of quilt center.

19. Outer Border: Sew (2) **C** 2-1/2" x 45-1/2" strips to the left and right sides of quilt center, followed by (2) **C** 2-1/2" x 43-1/2" strips to the top and bottom of quilt center to finish.



# Flower Meadow

## QUILT ASSEMBLY DIAGRAM

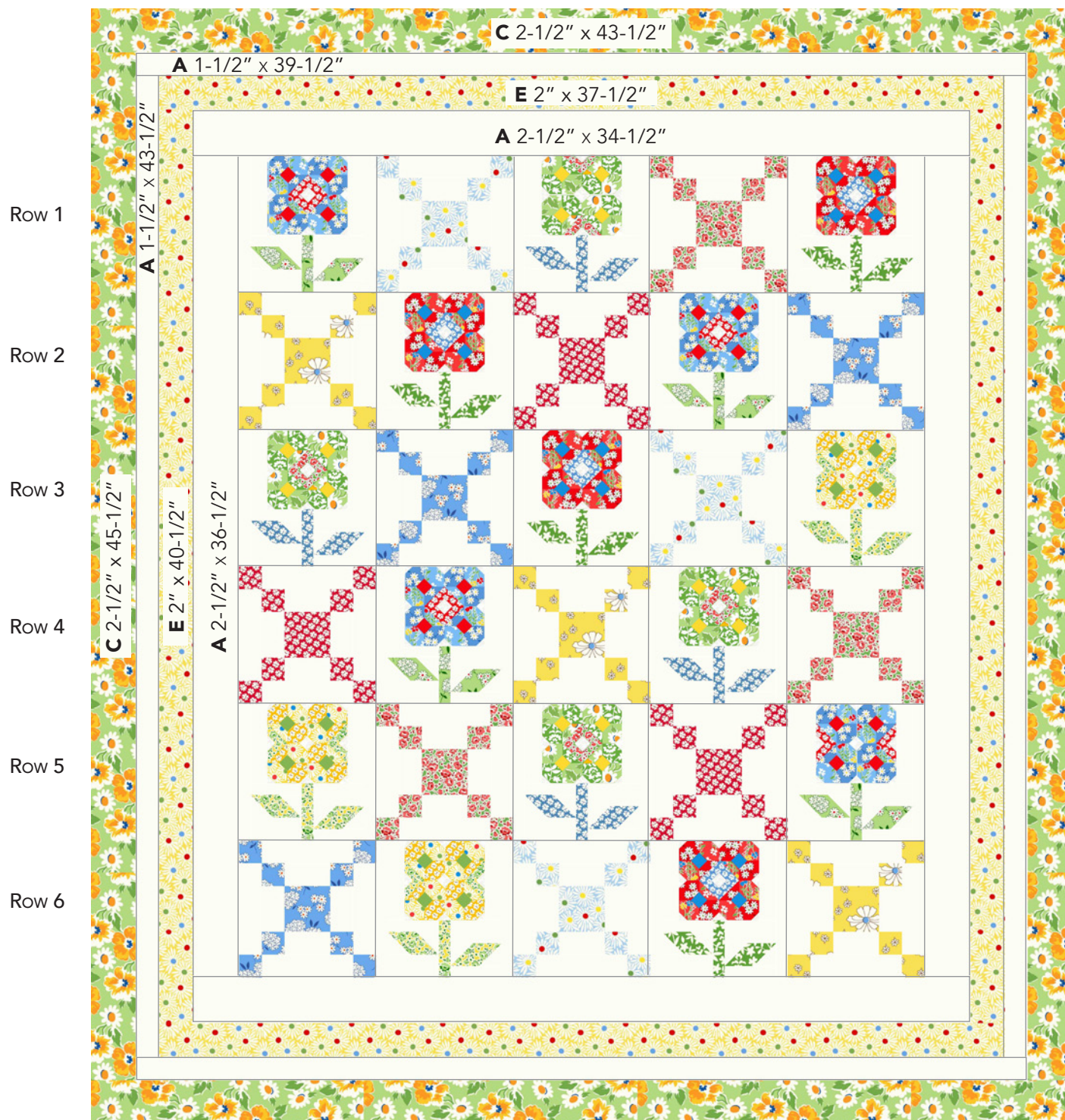

**FINISHING:** Layer quilt top, batting and backing together to form quilt sandwich. Baste and quilt as desired. Bind using **J** 2-1/4" strips.