



Mystic Ocean Quilt



Finished Size: 39 ½" x 45 ½" (100.33cm x 115.57cm)

Fabric Needed

3 Wishes Fabric® Mystic Ocean Collection by Josephine Wall

- 1 yd Panel (91.44cm) – Mermaid Panel (14606-Multi)
- ½ yd (45.72cm) – Coral Reef (14607-Multi)
- ½ yd (45.72cm) – Seahorses (14611-Blue) for Binding
- ⅛ yd (11.43cm) – Bubbles (14608-Green)
- ⅛ yd (11.43cm) – Reflection (14609-Yellow)
- ⅛ yd (11.43cm) – Waves (14612-Multi)
- 1 ½ yds (137.16cm) – Mermaids (14610-Blue) for Backing

ADDITIONAL SUPPLIES NEEDED:

- 48" x 54" (121.92cm x 137.16cm) Cotton batting
- Piecing and sewing thread
- Quilting and sewing supplies
- Even-feed foot (optional for quilting)

Before you begin

Read all instructions before beginning project. Do not pre-wash fabrics. Press fabrics with a dry iron on cotton setting before cutting. Use a ¼" (6.35mm) seam allowance and sew fabrics with right sides together (RST) unless otherwise noted. Press seams in the direction of the arrows. wof = width of fabric.

Cutting

1. Use a rotary cutter and acrylic ruler to cut the number of pieces from each fabric listed below.



Panel (14606 – Multi) / 1 yd Panel (91.44cm x 106.68cm)

Fussy Cut 1 – 33 ½" x 39 ½" (85.09cm x 100.33cm)

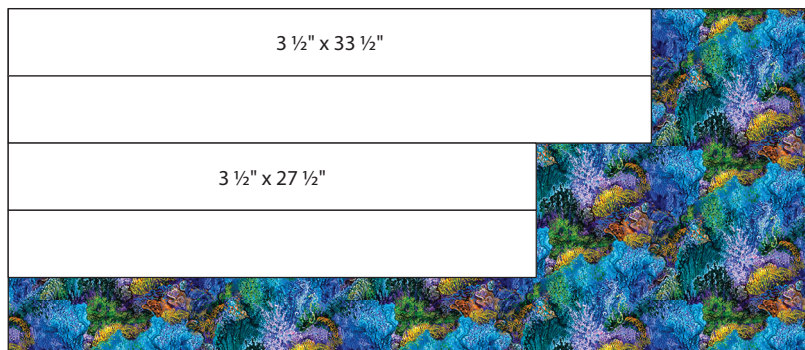

Coral Reef (14607 – Multi) / 18" x wof (45.72cm x 106.68cm)

Cut 2 – 3 ½" x 33 ½" (8.89cm x 85.09cm)

Cut 2 – 3 ½" x 27 ½" (8.89cm x 69.85cm)



Bubbles (14608 – Green) / 4 ½" x wof (11.43cm x 106.68cm)

Cut 4 – 3 ½" x 3 ½" (8.89cm x 8.89cm)

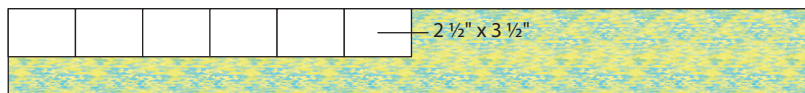

Reflection (14609 – Yellow) / 4 ½" x wof (11.43cm x 106.68cm)

Cut 6 – 2 ½" x 3 ½" (6.35cm x 8.89cm)



Waves (14612 – Multi) / 4 ½" x wof (11.43cm x 106.68cm)

Cut 6 – 2 ½" x 3 ½" (6.35cm x 8.89cm)

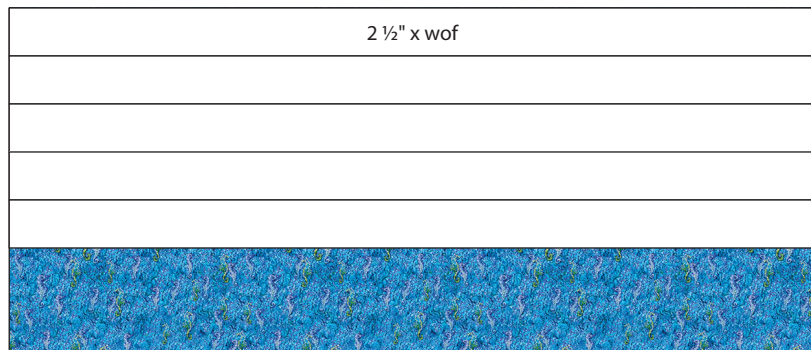

Seahorses (14611 – Blue) / 18" x wof (45.72cm x 106.68cm)

Cut 5 – 2 ½" x wof (6.35cm x 106.68cm)

- Place one Coral Reef rectangle (3 1/2" x 27 1/2" / 8.89cm x 69.85cm), three Waves rectangles (2 1/2" x 3 1/2" / 6.35cm x 8.89cm) and three Reflection rectangles (2 1/2" x 3 1/2" / 6.35cm x 8.89cm) as shown in Diagram A. Pin RST and sew; press. Repeat to make two Side Borders (3 1/2" x 39 1/2" / 8.89cm x 100.33cm).

Dia. A

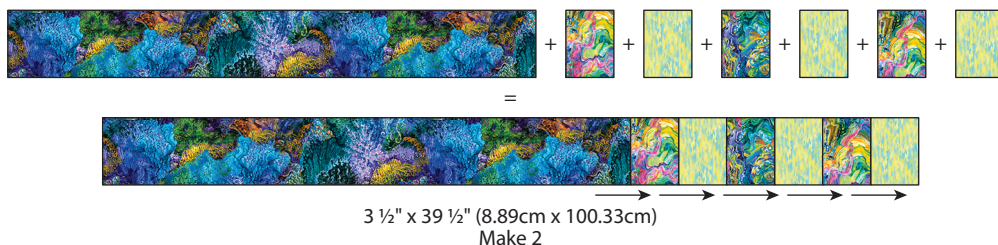

- Place two Bubbles squares (3 1/2" x 3 1/2" / 8.89cm x 8.89cm) on each end of one Coral Reef rectangle (3 1/2" x 33 1/2" / 8.89cm x 85.09cm) to make the Top Border as shown in Diagram B. Pin RST and sew; press. Repeat to make the Bottom Border (3 1/2" x 39 1/2" / 8.89cm x 100.33cm).

Dia. B

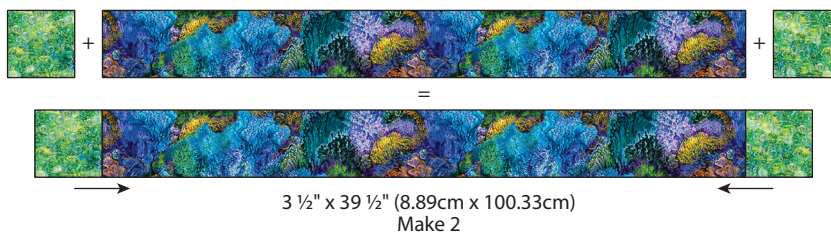

- Refer to Diagram C to add the Borders to the Fussy Cut Mermaid Panel rectangle (33 1/2" x 39 1/2" / 85.09cm x 100.33cm). Place the Side Borders as shown.

Note: The borders are turned 180° from each other. Pin RST matching centers and ends and sew to the sides; press. Place the Top and Bottom Borders as shown. Pin RST matching the centers and seams and sew to top and bottom edges; press. The finished quilt top should measure 39 1/2" x 45 1/2" (100.33cm x 115.57cm).

- The 1 1/2 yards (137.16cm) of Mermaids backing is sufficient to cover the length and width of the top. If using a long arm machine to quilt, extra fabric basted onto backing edges might be necessary.
- Press finished quilt top and backing. Tape the backing **wrong** side up to a firm surface. Layer batting and quilt top (right side up). Baste the layers together with safety pins. Quilt as desired.

Dia.C



7. Once quilting is complete, square up corners and edges, trimming excess backing and batting even with the quilt top.
8. To make the Seahorses binding, remove selvages and sew the short ends of the five 2 ½" x wof (6.35cm x 106.68cm) strips RST end to end at a 45° angle to make one continuous strip; press seams open. Press one short end ¼" (6.35mm) to the **wrong** side. Fold in half lengthwise with **wrong** sides together; press. Leaving a 2" (5.08cm) tail on the folded end, place cut edges of folded binding even with the edge of the quilt top and sew, mitering the corners. Overlap ends, trim any excess and finish sewing the binding. Fold binding over to back and hand stitch.

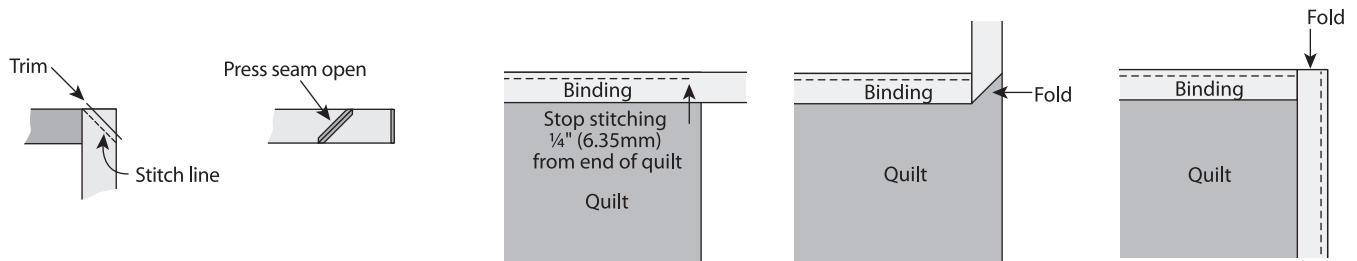

Finished Care Instructions

Machine wash in cold water; gentle cycle. **Tip:** Before drying, check for fabric dyes that may have run. If fabric dyes run, rewash and rinse using color catcher to absorb loose dye. Lay flat to dry or tumble dry low.